

Sealing and assembly flywheel housing

Rear crankshaft seal

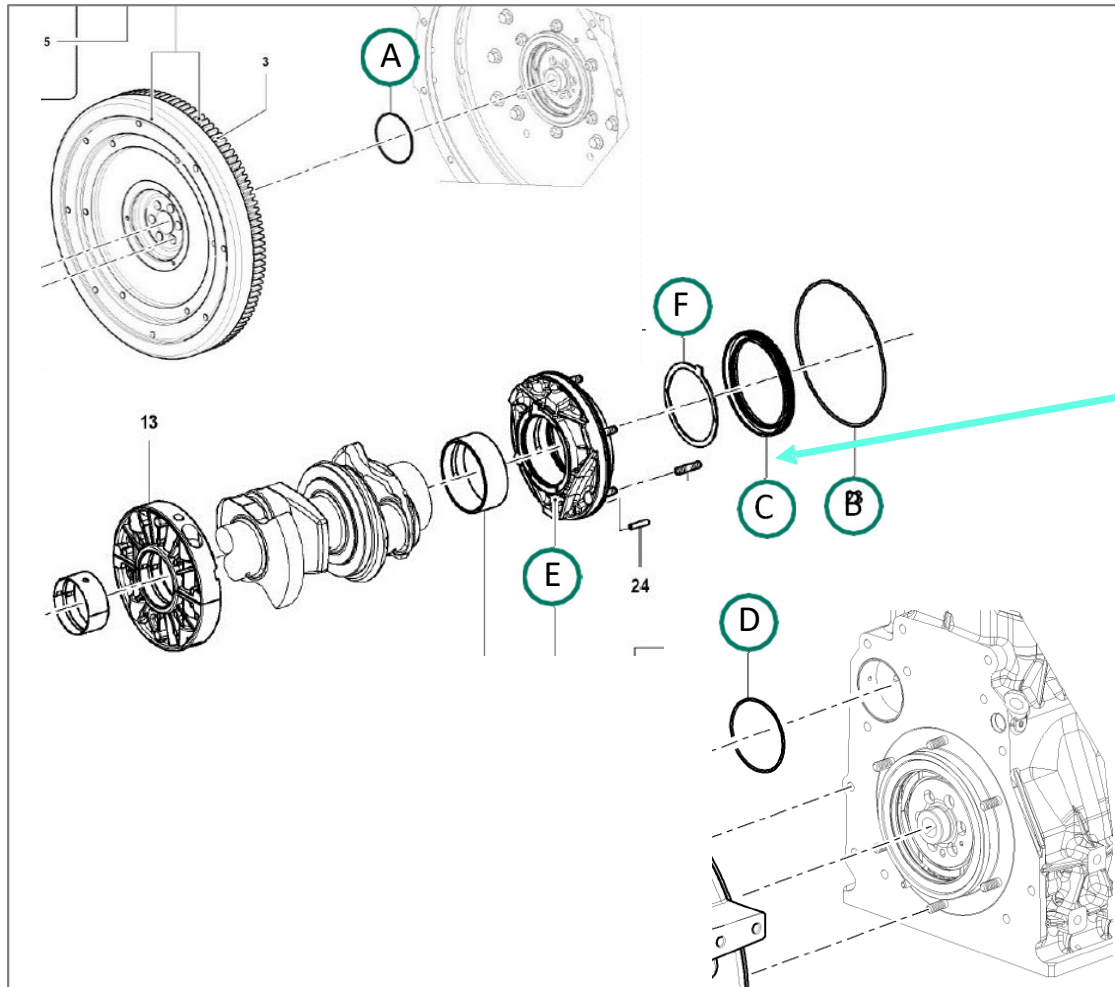

When working in the rear sealing area, always replace all seals (position A-D) as shown in the picture.

Glue shaft seal (C) into bearing bracket (E) with Loctite 510.

- A O-ring Crankshaft Part
Number: 4 632 0230
- B O-ring bearing bracket
outside Part number: 4
632 0270
- C Oil seal in bearing bracket Part
number: 4 634 0869
- D O-Ring Camshaft Part
Number: 4 632 0250
- E Bearing bracket
- F Thrust washer

Application Surface sealant

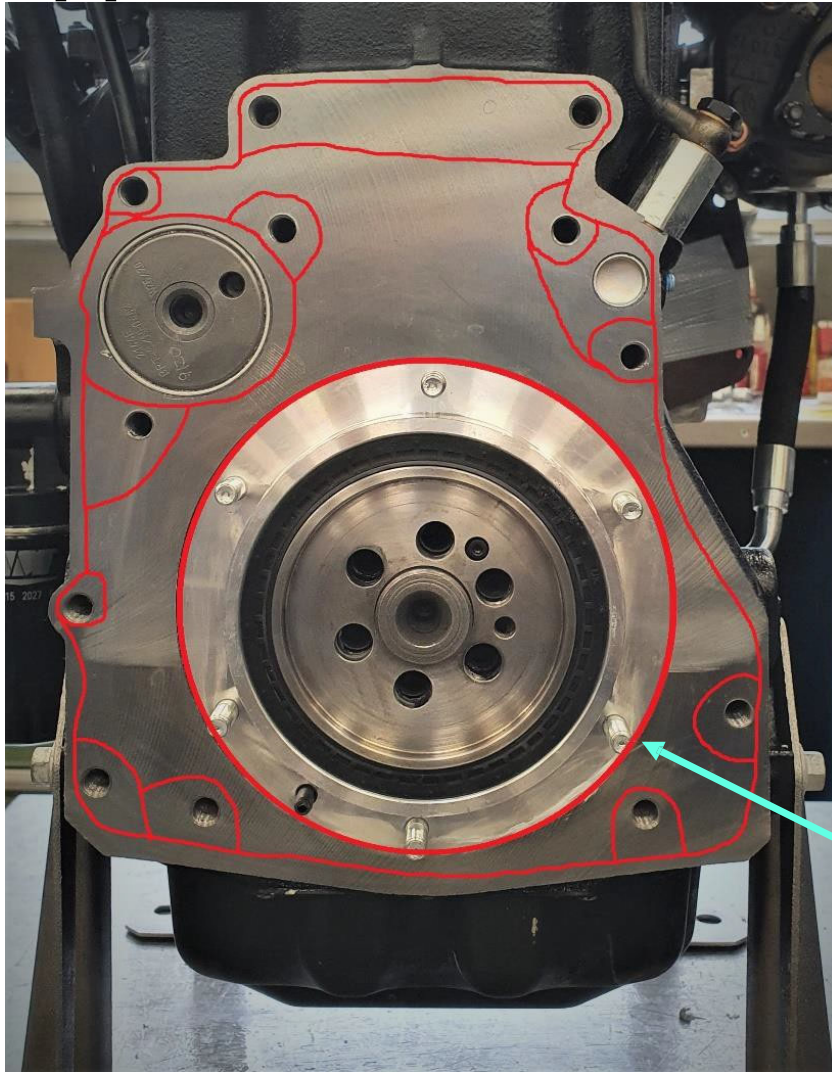

When mounting the flywheel housing, an additional surface sealant (e.g. Loctite 53-99) must be used between the engine block and the flywheel housing. In the picture on the left, the area for applying the sealant is shown in red. It is important to reproduce all the shapes shown in red as in the picture.

Also apply sealant to the groove between the bearing bracket and the engine block.

Tightening values in the flywheel housing area

Designation	Nm Tightening torque
Flywheel housing bolts to engine block	68.5 Nm
Flywheel on crankshaft (M12x1.25)	110 Nm
Nut flywheel housing to skin bearing bracket	24.5 Nm (use screw lock)